

meviy, an AI-based parts procurement platform,  
**“Quick Delivery” for CNC Turning Parts Now Available**  
- reduces order-to-shipment time significantly,  
now ships as early as the 3<sup>rd</sup> day after order receipt -

meviy, an AI-based parts procurement platform powered by MISUMI Group Inc. (Headquarters: Chiyoda-ku, Tokyo, Japan; Representative Director and President: Ryusei Ono), will start offering a quick delivery option for CNC turning parts (round) on January 9, 2024. The new service provides customers with the option of shipping as early as the 3rd day after order receipt, compared to the 6th day previously. This allows us to meet urgent needs for parts procurement, such as sudden design changes or machine breakdowns.

We will continue to provide time value to our global IA (Industrial Automation) customers and help them improve their productivity by enhancing our services.



**Quick Delivery**  
Now Available for  
**CNC Turing Parts.**  
ship as early as  
**DAY 3**



■ **Background**

To meet the diverse needs of our customers, meviy offers several services that allow customers to choose the desired delivery dates and prices.

For customers who purchase parts with a priority for quick delivery (in case of sudden design changes or machine breakdowns), both the "Ultra Quick Delivery" and "Quick Delivery" options are available so that products can be delivered in the shortest possible time while maintaining the same product quality. On the other hand, for customers whose top priority is price (specifically, those who systematically order "items they do not need in a hurry"), we offer the "Long Delivery Time, Low Price" option, which discounts products by up to 30% without changing the quality\*1.

The "Quick Delivery" option, the enhanced feature of this time, has expanded its coverage to include sheet

metal parts<sup>\*2</sup> and CNC milling parts (square)<sup>\*3</sup> since August 2019, and many requests have been received to include CNC turning parts (round). Now that we have strengthened our production capacity, we can finally meet the customer's demand for procuring CNC turning parts (round) with short delivery time, as already available for CNC milling parts (square) and sheet metal parts. We are sure that our new service, the "Quick Delivery" option for CNC turning parts (round), will prove useful for our customers in many situations.

\*1 Press Release: The "Long Delivery Time, Low Price" service for FA parts launches (July 4, 2022)

[https://www.misumi.co.jp/assets/doc/ir/news/news\\_220704.pdf](https://www.misumi.co.jp/assets/doc/ir/news/news_220704.pdf)

\*2 Press Release: "Delivery time for shipping of sheet metal parts significantly reduced to a minimum of one day from order receipt" (August 2, 2019)

[https://www.misumi.co.jp/assets/doc/ir/news/news\\_190802.pdf](https://www.misumi.co.jp/assets/doc/ir/news/news_190802.pdf)

\*3 Press release "Cutting plate parts can now be shipped within one day from order receipt at the earliest" (July 25, 2022)

[https://www.misumi.co.jp/assets/doc/ir/news/news\\_220725.pdf](https://www.misumi.co.jp/assets/doc/ir/news/news_220725.pdf)

## ■ Service Overview

**Release date:** January 9, 2024

**Newly added feature:** "Quick Delivery" option for CNC turning parts (round)

**Materials applicable to the new feature:** Iron, steel, aluminum, SUS, resin (only MC nylon (blue) and POM (white and black) are supported)

**Surface treatment available with the new feature:** Electroless nickel, black dyed, white anodized, black anodized (Processing time is now reduced to +1 day from + 2days previously.)

"Quick Delivery" option is also available for other surface treatments.

**Heat treatment available with the new feature:** Total quenching

**Delivery time:** Ship as early as the third day from order receipt

For more information on the services please see below.

▼meviy Website: Service information (in Japanese)

<https://jp.meviy.misumi-ec.com/info/ja/archives/41225/>

▼meviy Website: Technical Information > CNC Turning Parts (Round) > Product Coverage > Shipping Date (in Japanese)

[https://jp.meviy.misumi-ec.com/help/ja/technical\\_info/tup\\_shape-material/12589/](https://jp.meviy.misumi-ec.com/help/ja/technical_info/tup_shape-material/12589/)

## ▼Two examples of how the "Quick Delivery" option can reduce delivery time

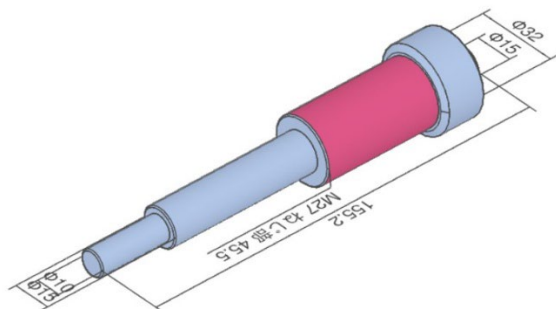

CNC Turning Only

(Ship on Day6 → Ship on Day 3 with "Quick Delivery" option)

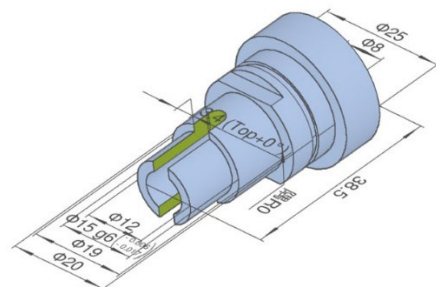

Additional Machining Ordered

(Ship on Day 8 → Ship on Day 4 with "Quick Delivery" option)

## ■ About meviy

With meviy, customers simply upload a 3D model of a mechanical component, the AI automatically provides an instant quote, and our unique Digital Manufacturing System enables an order to be shipped in one day at the earliest.

meviy is a platform that eliminates perceived inefficiencies in parts procurement by reducing the time customers traditionally spend procuring mechanical components by more than 90%.

meviy received the Prime Minister's Prize at the Ninth Monodzukuri Nippon Grand Awards, achieved the No. 1 market share in Japan for three consecutive years, and is highly regarded for its contributions to improving productivity in the manufacturing industry. For our global customers, the range of services on each meviy website is expanding. meviy delivers "time value" to customers worldwide through digital transformation in component procurement.

meviy Japan website <https://meviy.misumi-ec.com/>

Customer testimonials (in Japanese)

[https://jp.meviy.misumi-ec.com/info/ja/archives/category/case/user\\_case/](https://jp.meviy.misumi-ec.com/info/ja/archives/category/case/user_case/)

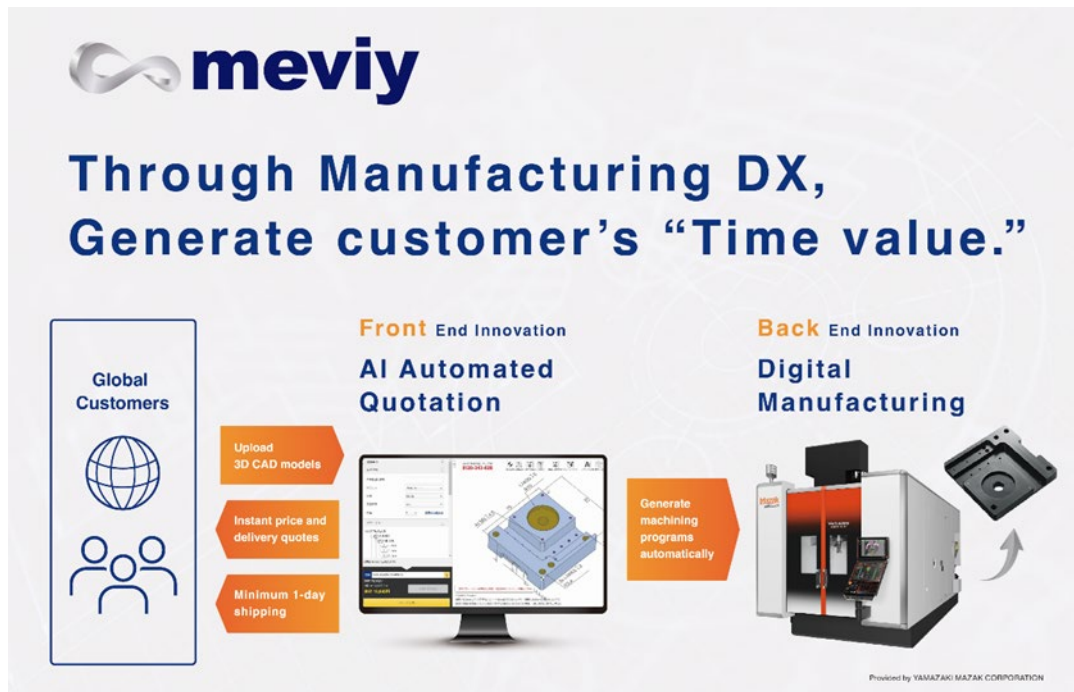

## ■ About MISUMI

MISUMI sells mechanical components required on-site for factory automation, as well as tools, consumables, and other products to more than 320,000 companies\*<sup>4</sup> worldwide. We wear two hats: a manufacturer with manufacturing functions and a distributor of other company's branded products. With this unique business model, supported by a solid business base, MISUMI achieves "globally reliable, quick delivery" for greater customer convenience. \*<sup>4</sup> As of March 2023

【For inquiries regarding this press release, please contact】

Matsubara

email: [pr@misumi.co.jp](mailto:pr@misumi.co.jp)

Tel: 03-6777-7502

Corporate Relations Department

MISUMI Group Inc.